

# critical cyborg

## carrie furnace, rankin, pa

ISSUE DATE 8/29/18

DUE DATE 8/31/18 10pm

**Top** -1944 Map Carrie Furnace with current buildings shaded.

**Bottom** - left, Kandinsky drawing, right top Mark Schendel OMA, Lille, bottom Smout Allen, truck movement.

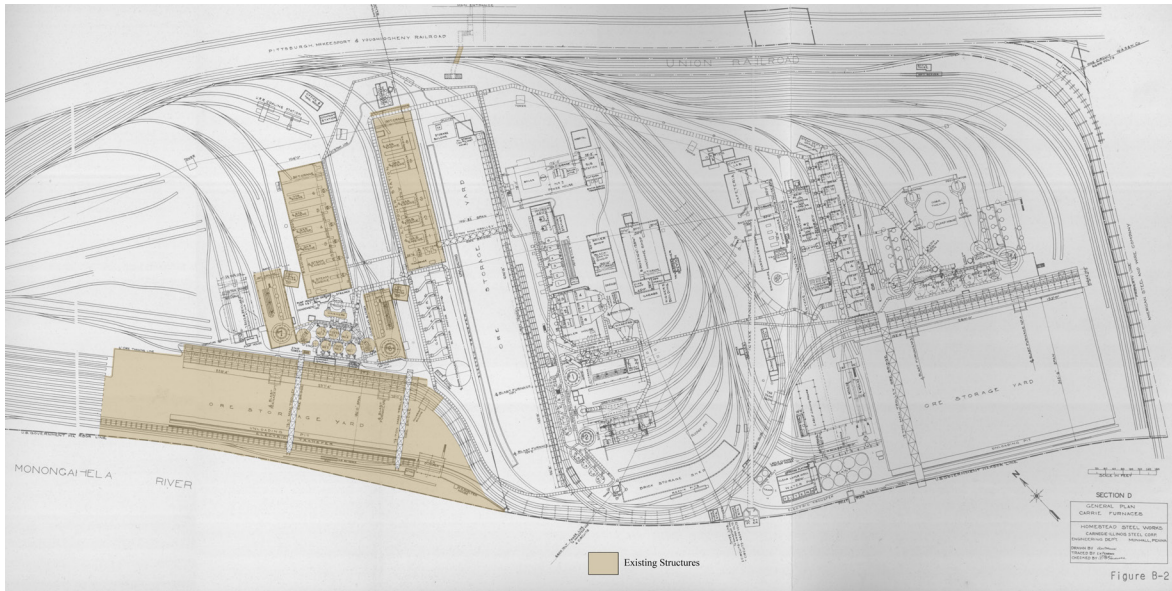

### INSTRUCTIONS

Be at the MMRotunda at 12.50pm for bus departure at 1.00pm. Check in with your instructor before getting onto the bus.

We will be outside all afternoon so wear clothes that are suitable for a rough environment. You might be close to weeds, rocks or sharp metal pieces so watch where you are going. You **MUST** be wearing closed shoes.

It will be long, it might be hot; bring plenty of water, consider bringing snacks use sunscreen, carry layers.

The bus will arrive back at campus any time between 5.15-5.30pm.

### DELIVERABLES

You will make ten analytical drawings. Take pictures of them with your phone/camera and then upload them onto Realtime Board by 10pm on 8/31/18

On our visit to Carrie Furnace we will first to have a tour of the site by the historians which will take 1.5 hours. After the tour you will spend the rest of the time making analytical drawings of a part of the industrial space of your choosing.

Bring with you the newsprint pad, your drawing clipboard, charcoal and a variety of pens. Make sure your clipboards and pads are marked with your name.

### ANALYTICAL DRAWING

Imagine how this installation is assembled and what is the operative principal. Draw the relationships of parts that you might have understood or projected from your observations.

